

## Industrial keyless chuck

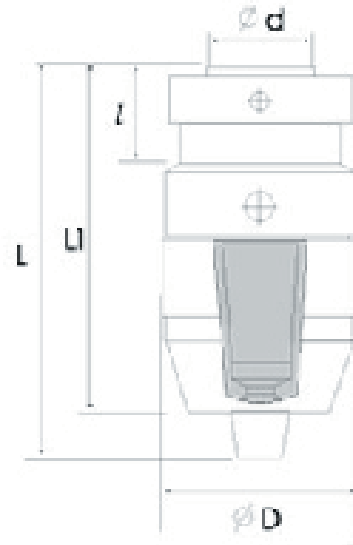

### Application

Recommended for CNC machining center.

### Features

1. High precision, and high gripping force, high reliability and stability.
2. Flimsy parts are shaped by quenching.
3. Self-tighting feature automatically increase gripping force proportional to increased torque to prevent tool shank slippage.

Order NO.	Capacity	Arbor Taper	Taper	d	i	D	L	L1	kg	Check rod		Precision Grade		N.M
				mm	mm	mm	mm	mm		Big	Small	M	P	
436-7684	0.5-6mm	B10	2°51' 26.7"	10.094	14.5	34	71.2	61.4	0.32	6×65	4×45	0.06	0.08	3
436-7685	1/64" -1/4"	JT1	4°24' 53.1"	9.754	16.669									
436-7686	0.5-8mm	B12	2°51' 26.7"	12.065	18.5	34	71.2	61.4	0.5	8×80	4×45	0.06	0.1	4
436-7687	1/64" -5/16"	JT2	4°40' 11.6"	14.199	22.225									
436-7688	1.0-10mm	B12	2°51' 26.7"	12.065	18.5	44	93.4	81	0.7	9×95	5×60	0.06	0.1	6
436-7689	1/32" -3/8"	JT2	4°40' 11.6"	14.199	22.225									
436-7690	1-13mm	B16	2°51' 41.0"	15.733	24	51	106	94	0.96	13×105	6×65	0.06	0.1	12
436-7691	1/32" -1/2"	JT33	3°38' 13.4"	15.85	25.4									
436-7692	1.0-16mm	B18	2°51' 41.0"	17.78	32	54	115.2	102	1.24	16×110	8×80	0.06	0.1	14
436-7693	1/32" -5/8"	JT6	2°58' 24.8"	17.17	25.4									
436-7694	5.0-20mm	B22	2°52' 31.5"	21.793	40.5	57	129.2	115	1.7	20×120	10×95	0.06	0.1	16
436-7695	3/16" -3/4	JT3	3°3' 3"	20.599	30.956									

## Industrial keyless chuck

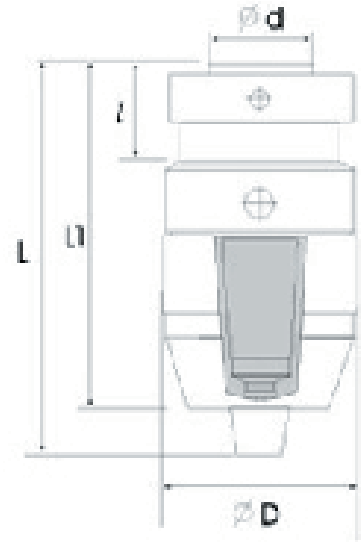

### Application

Recommended for CNC machining center.

### Features

1. High precision, and high gripping force, high reliability and stability.
2. Flimsy parts are shaped by quenching.
3. Self-tighting feature automatically increase gripping force proportional to increased torque to prevent tool shank slippage.

Order No.	Capacity	Arbor Taper	Taper	d	i	D	L	L1	kg	Check rod Size		Precision Grade		N.M
	Number			mm	mm					mm	mm	mm	mm	
436-7696	0.3-4mm 1/64" -5/32"	JTO	2°49' 24.7"	6.35	11.112	29	60.8	55	-	4x45	-	0.05	0.08	1.2
436-7697	0.5-6mm	B10	2°51' 26.7"	10.094	14.5	34	70.6	64	0.32	6x65	4x45	0.05	0.1	3
436-7698	1/64" -1/4"	JT1	4°24' 53.1"	9.754	16.669									
436-7699	0.5-8mm	B12	2°51' 26.7"	12.065	18.5	39	80.4	73	0.5	8x80	4x45			
436-7700	1/64" -5/16"	JT2	4°40' 11.6"	14.199	22.225									
436-7701	1.0-10mm	B12	2°51' 26.7"	12.065	18.5	44	90.2	82	0.7	9x95	5x60			6
436-7702	1/32" -3/8"	JT2	4°40' 11.6"	14.199	22.225									
436-7703	1.0-13mm	B16	2°51' 41.0"	15.733	24	49	100.6	91	0.96	13x105	6x65	12		
436-7704	1/32" -1/2"	JT33	3°38' 13.4"	15.85	25.4									
436-7705	1.0-16mm	B18	2°51' 41.0"	17.78	32	54	112.2	102	1.24	16x110	8x80	0.05	0.1	14
436-7706	1/32" -5/8"	JT6	2°58' 24.8"	17.17	25.4									
436-7707	5.0-20mm	B22	2°52' 31.5"	21.793	40.5	59	124.2	116	1.7	20x120	10x95	0.05	0.1	16
436-7708	3/16" -3/4"	JT3	3°3' 3"	20.599	30.956									

## Industrial keyless chuck

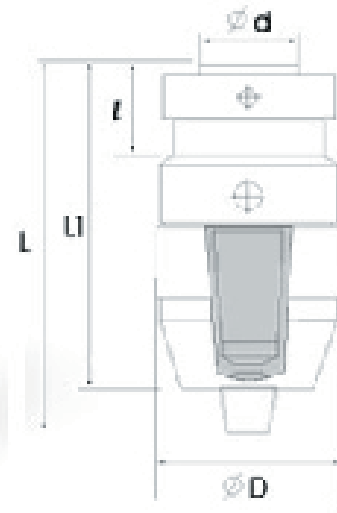

### Application

Recommended for CNC machining center.

### Features

1. High precision, and high gripping force, high reliability and stability.
2. Flimsy parts are shaped by quenching.
3. Self-tighting feature automatically increase gripping force proportional to increased torque to prevent tool shank slippage.

OrderNO.	Capacity	Ta- pering	Taper	d	l	D	L	L1	kg	Check rod Size		Precision Grade		N.M
				mm	mm	mm	mm	mm		Big	Small	M	P	
436-7709	0.3-4mm	JTO	2°49' 24.7"	6.35	11.112	29	60.8	55	-	4×45	-	0.06	0.08	1.2
	1/16"-5/32"													
436-7710	0.5-6mm	B10	2°51' 26.7"	10.094	14.5	34	71.2	64	0.32	6×65	4×45	0.05	0.1	3
436-7711	1/16"-1/4"	JT1	4°24' 53.1"	9.754	16.669									
436-7712	0.5-8mm	B12	2°51' 26.7"	12.065	18.5	34	71.2	73	0.32	8×80	4×45	0.05	0.1	4
436-7713	1/16"-5/16"	JT2	4°40' 11.6"	14.199	22.225									
436-7714	1.0-10mm	B12	2°51' 26.7"	12.065	18.5	44	93.4	82	0.7	10×95	5×60	0.05	0.1	6
436-7715	1/32"-3/8"	JT2	4°40' 11.6"	14.199	22.225									
436-7716	1.0-13mm	B16	2°51' 41.0"	15.733	24	51.5	106	91	0.96	13×105	6×65	0.05	0.1	12
436-7717	1/32"-1/2"	JT33	3°38' 13.4"	15.85	25.4									
436-7718	1.0-16mm	B18	2°51' 41.0"	17.78	32	54	115	102	1.24	16×110	8×80	0.05	0.1	14
436-7719	1/32"-5/8"	JT6	2°58' 24.8"	17.17	25.4									
436-7720	5.0-20mm	B22	2°52' 31.5"	21.793	40.5	57	129.2	116	1.7	20×120	10×95	0.05	0.1	16
436-7721	3/16"-3/4"	JT3	3°3' 3"	20.599	30.956									

## Industrial keyless chuck

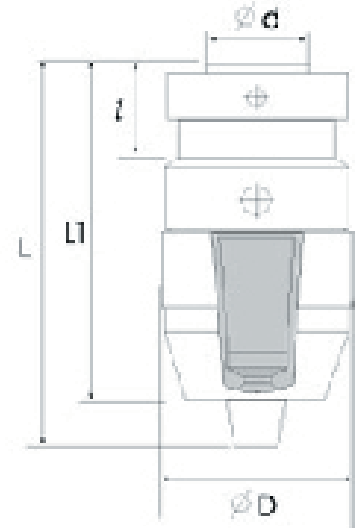

### Application

Recommended for CNC machining center.

### Features

1. High precision, and high gripping force, high reliability and stability.
2. Flimsy parts are shaped by quenching.
3. Self-tighting feature automatically increase gripping force proportional to increased torque to prevent tool shank slippage.

Order No.	Capacity	Tapering Hole	Taper	d	i	D	L	L1	kg	Check rod Size		Run-out (mm)	N.M
				mm	mm					mm	mm		
436-7722	0.5-6mm	B10	2°51' 26.7"	10.094	14.5	34	71.2	61.4	0.32	6×65	4×45	0.08	3
436-7723	1/64" -1/4"	JT1	4°24' 53.1"	9.754	16.669			61.4					
436-7724	0.5-8mm	B12	2°51' 26.7"	12.065	18.5	34	71.2	61.4	0.32	8×80	4×45	0.1	4
436-7725	1/64" -5/16"	JT2	4°40' 11.6"	14.199	22.225			61.4					
436-7726	1.0-10mm	B12	2°51' 26.7"	12.065	18.5	36	78	70	0.7	10×95	5×60	0.1	6
436-7727	1/32" -3/8"	JT2	4°40' 11.6"	14.199	22.25			70					
436-7728	1.0-13mm	B16	2°51' 41.0"	15.733	24	49	94.5	85.2	0.96	13×105	6×65	0.1	12
436-7729	1/32" -1/2"	JT33	3°38' 13.4"	15.85	25.4			44					
436-7730	3.0-16mm	B18	2°51' 41.0"	17.78	32	54	103	93	1.24	16×110	8×80	0.1	14
436-7731	1/32" -5/8"	JT6	2°58' 24.8"	17.17	25.4			50.5					
436-7732	5.0-20mm	B22	2°52' 31.5"	21.793	40.5	59	124.2	116	1.7	20×120	10×95	0.1	16
436-7733	3/16" -3/4"	JT3	3°3' 3"	20.599	30.956								

**Keyless Chuck With ISO Shank**

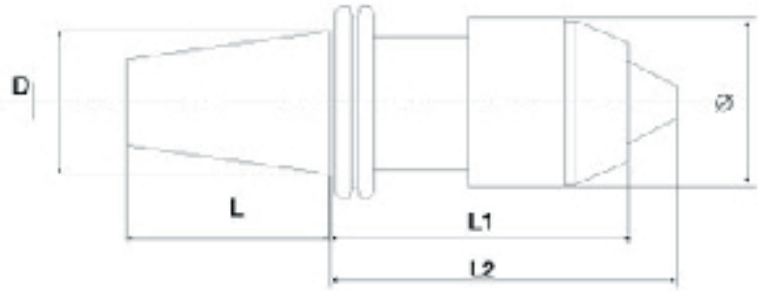

Order No.	Capacity		Arbor Taper	Dimensiones					Thread
	mm	Inch		φ	L1	L2	L	D	
436-7734	0-8mm	0-5/16"	30	38	101	107	48.5	31.75	1/2"-13
436-7735	0-8mm	0-5/16"	40	38	82	88	65.4	44.45	1/2"-13
436-7736	1-13mm	1/32"-1/2"	40	48	115	126	65.4	44.45	5/8"-11
436-7737	1-13mm	1/32"-1/2"	45	48	96	107	82.8	57.15	3/4"-10
436-7738	1-13mm	1/32"-1/2"	50	48	96	107	101.8	69.85	1"-8
436-7739	3-16mm	1/8"-5/8"	40	55	120	131	65.4	44.45	5/8"-11
436-7740	3-16mm	1/8"-5/8"	50	55	94	105	101.8	69.85	1"-8

**Keyless Chuck With ISO Shank**

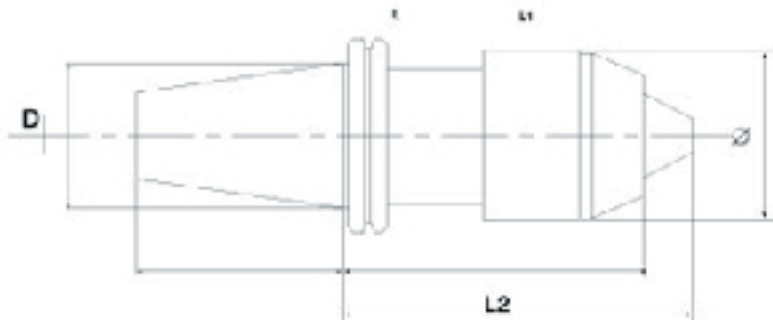

Order NO.	Capacity		Arbor Taper	Dimensiones					Thread
	mm	Inch		φ	L1	L2	L	D	
436-7741	0-8mm	0-5/16"	30	38	101	107	48.5	31.75	1/2"-13
436-7742	0-8mm	0-5/16"	40	38	82	88	65.4	44.45	1/2"-13
436-7743	1-13mm	1/32"-1/2"	40	48	115	126	65.4	44.45	5/8"-11
436-7744	1-13mm	1/32"-1/2"	45	48	96	107	82.8	57.15	3/4"-10
436-7745	1-13mm	1/32"-1/2"	50	48	96	107	101.8	69.85	1"-8
436-7746	3-16mm	1/8"-5/8"	40	55	120	131	65.4	44.45	5/8"-11
436-7747	3-16mm	1/8"-5/8"	50	55	94	105	101.8	69.85	1"-8

## Keyless Chuck With Integrated Shank

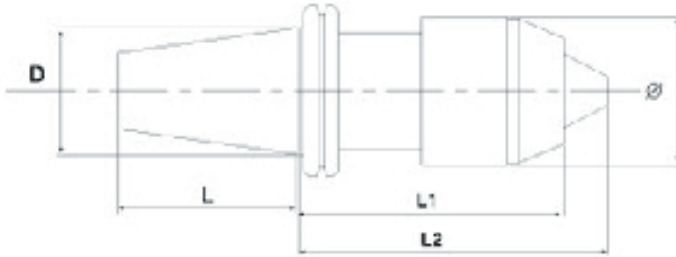

Order NO.	Capacity		Arbor Taper	Dimension					Thread
	mm	Inch		φ	L1	L2	L	D	
436-7748	0-8mm	0-5/16"	40	40	90	97	65.4	44.45	M16
436-7749	1-13mm	1/32"-1/2"	40	57	113	125	65.4	44.45	M16
436-7750	1-13mm	1/32-1/2"	50	57	93	105	101.8	69.85	M24
436-7751	3-16mm	1/8"-5/8"	40	57	115	127	65.4	44.45	M16
436-7752	3-16mm	1/8"-5/8"	50	57	96	107	101.8	69.85	M24

## Keyless Chuck With ISO Taper Shank

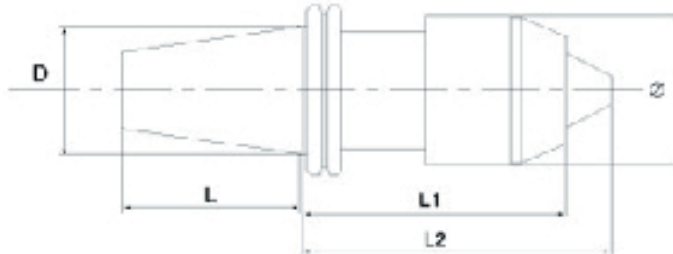

Order No.	Capacity		Arbor Taper	Dimension					Thread
	mm	Inch		ISO	φ	L1	L2	L	
436-7753	0-8mm	0-5/16"	40	40	90	97	65.4	44.45	M16
436-7754	1-13mm	1/32"-1/2"	40	57	113	125	65.4	44.45	M16
436-7755	1-13mm	1/32-1/2"	50	57	93	105	101.8	69.85	M24
436-7756	3-16mm	1/8"-5/8"	40	57	115	127	65.4	44.45	M16
436-7757	3-16mm	1/8"-5/8"	50	57	96	107	101.8	69.85	M24

## Keyless Chuck With ISO Taper Shank

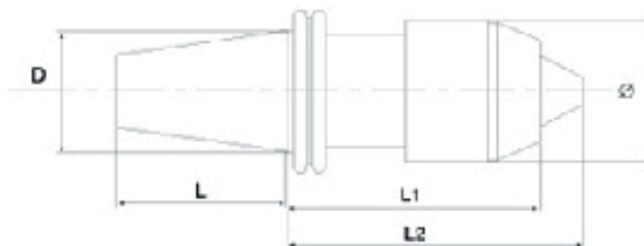

Order No.	Capacity		Arbor Shank	Dimensiones					Thread
	mm	Inch		φ	L1	L2	L	D	
436-7758	0-8mm	0-5/16"	40	40	90	97	65.4	44.45	M16
436-7759	1-13mm	1/32"-1/2"	40	57	113	125	65.4	44.45	M16
436-7760	1-13mm	1/32-1/2"	50	57	93	105	101.8	69.85	M24
436-7761	3-16mm	1/8"-5/8"	40	57	115	127	65.4	44.45	M16
436-7762	3-16mm	1/8"-5/8"	50	57	96	107	101.8	69.85	M24

**Keyless Chuck With ISO Taper Shank**

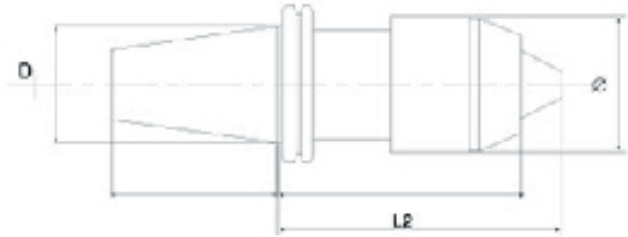

Order No.	Capacity		Arbor Taper	Dimension					Thread
	mm	Inch		ISO	φ	L1	L2	L	
436-7763	0-8mm	0-5/16"	30	38	101	107	48.5	31.75	1/2"-13
436-7764	0-8mm	0-5/16"	40	38	82	88	65.4	44.45	1/2"-13
436-7765	1-13mm	1/32"-1/2"	40	48	115	126	65.4	44.45	5/8"-11
436-7766	1-13mm	1/32"-1/2"	45	48	96	107	82.8	57.15	3/4"-10
436-7767	1-13mm	1/32"-1/2"	50	48	96	107	101.8	69.85	1"-8
436-7768	3-16mm	1/8"-5/8"	40	55	120	131	65.4	44.45	5/8"-11
436-7769	3-16mm	1/8"-5/8"	50	55	94	105	101.8	69.85	1"-8

**Keyless Chuck With ISO Taper Shank**

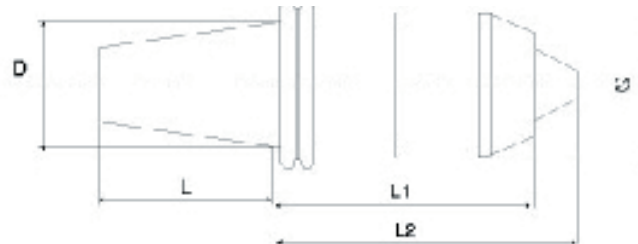

Order NO.	Capacity		Arbor Taper	Dimensions					Thread
	mm	Inch		ISO	φ	L1	L2	L	
436-7770	0-8mm	0-5/16"	40	40	90	97	65.4	44.45	M16
436-7771	1-13mm	1/32"-1/2"	40	57	113	125	65.4	44.45	M16
436-7772	1-13mm	1/32"-1/2"	50	57	93	105	101.8	69.85	M24
436-7773	3-16mm	1/8"-5/8"	40	57	115	127	65.4	44.45	M16
436-7774	3-16mm	1/8"-5/8"	50	57	96	107	101.8	69.85	M24

**Keyless Chuck With ISO Taper Shank**



Order NO.	Capacity		Arbor Taper	Dimensions					Thread
	mm	Inch		ISO	φ	L1	L2	L	
436-7775	0-8mm	0-5/16"	40	40	90	97	65.4	44.45	M16
436-7776	1-13mm	1/32"-1/2"	40	57	113	125	65.4	44.45	M16
436-7777	1-13mm	1/32"-1/2"	50	57	93	105	101.8	69.85	M24
436-7778	3-16mm	1/8"-5/8"	40	57	115	127	65.4	44.45	M16
436-7779	3-16mm	1/8"-5/8"	50	57	96	107	101.8	69.85	M24

# DRILL CHUCKS

## Keyless Chuck With BT Taper Shank

### Features:

- \* This integrated design makes it impossible for the arbor and the drill chuck to become accidentally separated.
- \* High precision and high gripping force, high reliability and stability.
- \* Flimsy parts are shaped by quenching.
- \* Self-tightening feature automatically increase gripping force proportional to increased torque to prevent tool shank slippage.

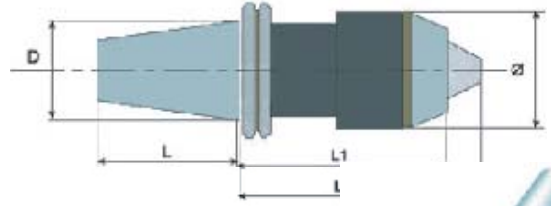

Order No.	Capacity		Drill Chuck Arbor	Dimension					Thread
	mm	Inch		BT	φ	L1	L2	L	
436-7780	0-8mm	0-5/16"	40	40	90	97	65.4	44.45	M16
436-7781	1-13mm	1/32"-1/2"	40	57	113	125	65.4	44.45	M16
436-7782	1-13mm	1/32"-1/2"	50	57	93	105	101.8	69.85	M24
436-7783	3-16mm	1/8"-5/8"	40	57	115	127	65.4	44.45	M16
436-7784	3-16mm	1/8"-5/8"	50	57	96	107	101.8	69.85	M24

## Keyless Chuck With BT Taper Shank

### Features:

- \* This integrated design makes it impossible for the arbor and the drill chuck to become accidentally separated.
- \* High precision and high gripping force, high reliability and stability.
- \* Flimsy parts are shaped by quenching.
- \* Self-tightening feature automatically increase gripping force proportional to increased torque to prevent tool shank slippage.

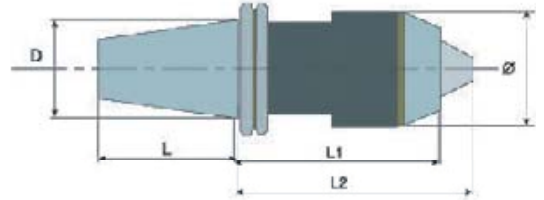

Order NO.	Capacity		Drill chuck Arbor	Dimensions					Thread
	mm	Inch		BT	φ	L1	L2	L	
436-7785	0-8mm	0-5/16"	30	38	101	107	48.5	31.75	1/2"-13
436-7786	0-8mm	0-5/16"	40	38	82	88	65.4	44.45	1/2"-13
436-7787	1-13mm	1/32"-1/2"	40	48	115	126	65.4	44.45	5/8"-11
436-7788	1-13mm	1/32"-1/2"	45	48	96	107	82.8	57.15	3/4"-10
436-7789	1-13mm	1/32"-1/2"	50	48	96	107	101.8	69.85	1"-8
436-7790	3-16mm	1/8"-5/8"	40	55	120	131	65.4	44.45	5/8"-11
436-7791	3-16mm	1/8"-5/8"	50	55	94	105	101.8	69.85	1"-8

## Keyless Chuck With Morse Taper Shank

### Features:

- \* High precision morse taper.
- \* This integrated design makes it impossible for the arbor and the drill chuck to become accidentally separated.
- \* High precision and high gripping force, high reliability and stability.
- \* Flimsy parts are shaped by quenching.
- \* Self-tightening feature automatically increase gripping force proportional to increased torque to prevent tool shank slippage.

Order NO.	Arbor Taper	Capacity		Dimensions			
		mm	Inch	D1	L1	L2	L
436-7792	MT3	1-13mm	1/32-1/2	51	181	192.5	99.5
436-7793	MT3	1-16mm	1/32-5/8	57	208	219.5	99.5

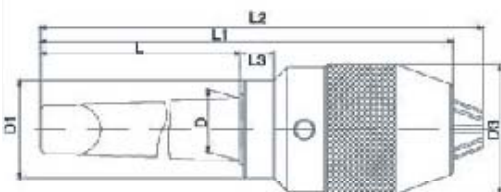



## Keyless Chuck With Morse Taper Shank

**Features:**

- 1.High precision morse taper.
- 2.This integrated design makes it impossible for the arbor and the drill chuck to become accidentally separated.
- 3.High precision and high gripping force,high reliability and stability.
- 4.Flimsy parts are shaped by quenching.
- 5.Self-tighting feature automatically increase gripping force proportional to increased torque to prevent tool shank slippage

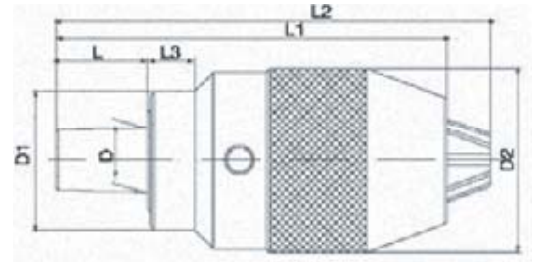

Order No.	Taper Shank	Capacity		Dimension				
		mm	Inch	D1	L1	L2	L	D
436-7794	MT3	1-13mm	1/32-1/2	51	108	119	26.5	23.825
436-7795	MT3	1-16mm	1/32-5/8	57	114.5	126	26.5	23.825



## Keyless Chuck With Taper Shank

**Features:**

- 1.High precision straight shank.
- 2.This integrated design makes it impossible for the arbor and the drill chuck to become accidentally separated.
- 3.High precision and high gripping force,high reliability and stability.
- 4.Flimsy parts are shaped by quenching.
- 5.Self-tighting feature automatically increase gripping force proportional to increased torque to prevent tool shank slippage.

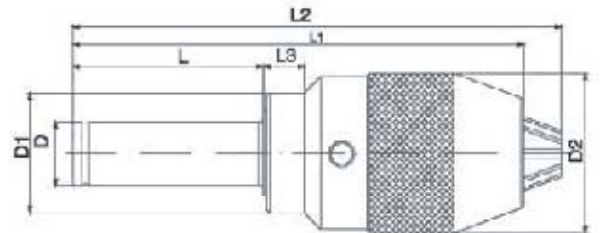

order No.	Shank Taper	Capacity		Dimensione				
		mm	Inch	D1	L1	L2	L	D
436-7796	C20	1-13mm	1/32-1/2	51	141.5	153	60	20
436-7797	C25	1-16mm	1/32-5/8	57	148	180	80	25



## Keyless Chuck With R8 Shank

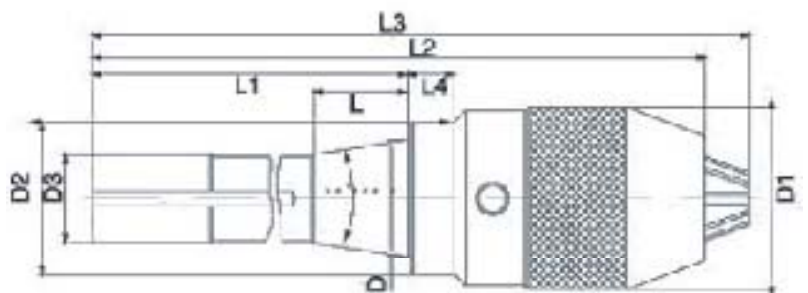

**Features:**

- 1.Mounts available:Morse tapers, straight shanks and R-8.
- 2.This integrated design makes it impossible for the arbor and the drill chuck to become accidentally separated.
- 3.High precision and high gripping force,high reliability and stability.
- 4.Flimsy parts are shaped by quenching.
- 5.Self-tighting feature automatically increase gripping force proportional to increased torque to prevent tool shank slippage.

Order No.	Shank Taper	Capacity		Dimensione				
		mm	Inch	D1	L1	L2	L	D
436-7798	R8	1-13mm	1/32-1/2	51	102	183	195	31.75
436-7799	R8	1-16mm	1/32-5/8	57	102	210	222	31.75

# DRILL CHUCKS

## Soft-Grip keyless chuck

- \* More comfortable and soft sleeve
- \* Positive gripping with easier tightening
- \* can apply more input torque, therefore more output torque is applied to the bit.
- \* Prevents your hands from being irritated during frequent tightening.
- \* Color and style can be made according to the customers' demands.
- \* Different colors can be chosen to match different drills.



Order NO.	Capacity		Mount	Body Diameter	Length Between Ends	Length
	mm	Inch		mm	mm	mm
436-7534	1.5-13	1/16-1/2	3/8-24UNF	49	62	75
436-7535	1.5-13	1/16-1/2	1/2-20UNF	49	62	75



## Soft-Grip keyless chuck

- \* More comfortable and soft sleeve
- \* Positive gripping with easier tightening can apply more input torque, therefore more output torque is applied to the bit.
- \* Prevents your hands from being irritated during frequent tightening.
- \* Color and style can be made according to the customers' demands.
- \* Different colors can be chosen to match different drills.

Order NO.	Capacity		Mount	Body Diameter	Length Between Ends	Length
	mm	Inch		mm	mm	mm
436-3536	1.5-13	1/16-1/2	3/8-24UNF	49	62	75
436-3537	1.5-13	1/16-1/2	1/2-20UNF	49	62	75

## With Lock System metal shell chuck

Application: Recommended for impact electric drills up to 800-1200W.

Features:

1. patented appearance with Human-based design, more comfortable and positive gripping can apply more output torque.
2. By using specialized anti-thrust bearing to convert hand-applied torque into superior gripping force.
3. patented positive lock system with "clack" feature indicating that the chuck is properly tightened, when rotate the front sleeve, which prevents loosening in hammer and other high-vibration applications.
4. Color and style can be made according to the customer's demands to match different drills.
5. Metal or plastic sleeves can be chosen according to the requirements.



Order NO.	Capacity		Mount	Body Diameter	Length Between Ends	Length
	mm	Inch		mm	mm	mm
436-7538	1.0-10	1/32-3/8	3/8-24UNF	41	56	66
436-7539	1.0-10	1/32-3/8	1/2-20UNF	41	56	66
436-7540	2.0-13	1/16-1/2	3/8-24UNF	43	67	75
436-7541	2.0-13	1/16-1/2	1/2-20UNF	43	67	75

STYLE B

## With Lock System metal shell chuck

Application: Recommended for impact electric drills up to 800-1200W.

Features:

- \* patented appearance with Human-based design, more comfortable and positive gripping can apply more output torque.
- \* By using specialized anti-thrust bearing to convert hand-applied torque into superior gripping force.
- \* patented positive lock system with "clack" feature indicating that the chuck is properly tightened, when rotate the front sleeve, which prevents loosening in hammer and other high-vibration applications.
- \* Color and style can be made according to the customer's demands to match different drills.
- \* Metal or plastic sleeves can be chosen according to the requirements.



Order NO.	Capacity		Mount	Body Diameter	Length Between Ends	Length
	mm	Inch		mm	mm	mm
436-7542	1.0-10	1/32-3/8	3/8-24UNF	41	56	66
436-7543	1.0-10	1/32-3/8	1/2-20UNF	41	56	66
436-7544	2.0-13	1/16-1/2	3/8-24UNF	42.5	67	75
436-7545	2.0-13	1/16-1/2	1/2-20UNF	42.5	67	75

## With Lock System metal shell chuck

Application: Recommended for impact electric drills up to 800-1200W.

Features:

- \* patented appearance with Human-based design, more comfortable and positive gripping can apply more output torque.
- \* By using specialized anti-thrust bearing to convert hand-applied torque into superior gripping force.
- \* Patented positive lock system with "clack" feature indicating that the chuck is properly tightened, when rotate the front sleeve, which prevents loosening in hammer and other high-vibration applications.
- \* Color and style can be made according to the customer's demands to match different drills.
- \* Metal or plastic sleeves can be chosen according to the requirements.



Order NO.	Capacity		Mount	Body Diameter	Length Between Ends	Length
	mm	Inch		mm	mm	mm
436-7546	1.0-10	1/32-3/8	3/8-24UNF	41	56	66
436-7547	1.0-10	1/32-3/8	1/2-20UNF	41	56	66
436-7548	2.0-13	1/16-1/2	3/8-24UNF	42.5	67	75
436-7549	2.0-13	1/16-1/2	1/2-20UNF	42.5	67	75

## With Lock System metal shell chuck

Application: Recommended for impact electric drills up to 800-1200W.

Features:

- \* Patented appearance with Human-based design, more comfortable and positive gripping can apply more output torque.
- \* By using specialized anti-thrust bearing to convert hand-applied torque into superior gripping force.
- \* patented positive lock system with "clack" feature indicating that the chuck is properly tightened, when rotate the front sleeve, which prevents loosening in hammer and other high-vibration applications.
- \* Color and style can be made according to the customer's demands to match different drills.
- \* Metal or plastic sleeves can be chosen according to the requirements.



Order No. mm	Capacity Mount		D mm	Body Diameter mm	Length Between Ends mm	Length mm
	mm	mm				
436-7550	1.0-10	1/32-3/8	1/2-20UNF	41	58	64
436-7551	1.0-10	1/32-3/8	3/8-24UNF	41	58	64
436-7552	2.0-13	1/16-1/2	1/2-20UNF	42.5	62	75
436-7553	2.0-13	1/16-1/2	3/8-24UNF	42.5	62	75

# DRILL CHUCKS

## With Lock System metal shell chuck

Application: Recommended for impact electric drills up to 800-1200W.

Features:

1. patented appearance with Human-based design, more comfortable and positive gripping can apply more output torque.
2. By using specialized anti-thrust bearing to convert hand-applied torque into superior gripping force.
3. patented positive lock system with "clack" feature indicating that the chuck is properly tightened, when rotate the front sleeve, which prevents loosening in hammer and other high-vibration applications.
4. Color and style can be made according to the customer's demands to match different drills.
5. Metal or plastic sleeves can be chosen according to the requirements.

Ordert No.	Capacity		Mount	Body Diameter	Length Between Ends	Length
	mm	Inch		mm	mm	mm
436-7554	0.8-10	1/32-3/8	3/8-24UNF	41	54	64
436-7555	0.8-10	1/32-3/8	1/2-20UNF	41	54	64
436-7556	2.0-13	1/16-1/2	3/8-24UNF	43	62	75
436-7557	2.0-13	1/16-1/2	1/2-20UNF	43	62	75



## With Lock System metal shell chuck

Application: Recommended for impact electric drills up to 800-1200W.

Features:

1. patented appearance with Human-based design, more comfortable and positive gripping can apply more output torque.
2. By using specialized anti-thrust bearing to convert hand-applied torque into superior gripping force.
3. patented positive lock system with "clack" feature indicating that the chuck is properly tightened, when rotate the front sleeve, which prevents loosening in hammer and other high-vibration applications.
4. Color and style can be made according to the customer's demands to match different drills.
5. Metal or plastic sleeves can be chosen according to the requirements.

Order No.	Capacity		Mount	Body Diameter	Length Between Ends	Length
	mm	Inch		mm	mm	mm
436-7558	0.8-10	1/32-3/8	3/8-24UNF	41.5	57	64
436-7559	0.8-10	1/32-3/8	1/2-20UNF	41.5	57	64
436-7560	2.0-13	1/16-1/2	3/8-24UNF	45	67	75
436-7561	2.0-13	1/16-1/2	1/2-20UNF	45	67	75



## With Lock System metal shell chuck

Application: Recommended for impact electric drills up to 800-1200W.

Features:

1. patented appearance with Human-based design, more comfortable and positive gripping can apply more output torque.
2. By using specialized anti-thrust bearing to convert hand-applied torque into superior gripping force.
3. patented positive lock system with "clack" feature indicating that the chuck is properly tightened, when rotate the front sleeve, which prevents loosening in hammer and other high-vibration applications.
4. Color and style can be made according to the customer's demands to match different drills.
5. Metal or plastic sleeves can be chosen according to the requirements.

Order NO.	Capacity		Mount	Body Diameter	Length Between Ends	Length
	mm	Inch		mm	mm	mm
436-7562	0.8-10	1/32-3/8	3/8-24UNF	41	54	64
436-7563	0.8-10	1/32-3/8	1/2-20UNF	41	54	64
436-7564	2.0-13	1/16-1/2	3/8-24UNF	43	67	75
436-7565	2.0-13	1/16-1/2	1/2-20UNF	43	67	75



## With Lock System metal shell chuck

Application: Recommended for impact electric drills up to 800-1200W.

Features:

1. patented appearance with Human-based design, more comfortable and positive gripping can apply more output torque.
2. By using specialized anti-thrust bearing to convert hand-applied torque into superior gripping force.
3. patented positive lock system with "clack" feature indicating that the chuck is properly tightened, when rotate the front sleeve, which prevents loosening in hammer and other high-vibration applications.
4. Color and style can be made according to the customer's demands to match different drills.
5. Metal or plastic sleeves can be chosen according to the requirements.

Order No.	Capacity		Mount	Body Diameter	Length Between Ends	Length
	mm	Inch		mm	mm	mm
436-7566	1.0-10	1/32-3/8	3/8-24UNF	41	56	66
436-7567	1.0-10	1/32-3/8	1/2-20UNF	41	56	66
436-7568	2.0-13	1/16-1/2	3/8-24UNF	43	67	75
436-7569	2.0-13	1/16-1/2	1/2-20UNF	43	67	75



## With Lock System metal shell chuck

Features:

1. patented appearance with Human-based design, more comfortable and positive gripping can apply more output torque.
2. By using specialized anti-thrust bearing to convert hand-applied torque into superior gripping force.
3. patented positive lock system with "clack" feature indicating that the chuck is properly tightened, when rotate the front sleeve, which prevents loosening in hammer and other high-vibration applications.
4. Color and style can be made according to the customer's demands to match different drills.
5. Metal or plastic sleeves can be chosen according to the requirements.

Order NO.	Capacity		Mount	Body Diameter	Length Between Ends	Length
	mm	Inch		mm	mm	mm
436-7570	2.0-13	1/16-1/2	3/8-24UNF	43	64	75
436-7571	2.0-13	1/16-1/2	1/2-20UNF	43	64	75



## With lock system plastic shell chuck

Application: Recommended for impact electric drills up to 600-950W.

Features:

1. patented appearance with Human-based design, more comfortable and positive gripping can apply more output torque.
2. By using specialized anti-thrust bearing to convert hand-applied torque into superior gripping force.
3. patented positive lock system with "clack" feature indicating that the chuck is properly tightened, when rotate the front sleeve, which prevents loosening in hammer and other high-vibration applications.
4. Color and style can be made according to the customer's demands to match different drills.
5. Metal or plastic sleeves can be chosen according to the requirements.

Order No	Capacity		Mount	Body Diameter	Length Between Ends	Length
	mm	Inch		mm	mm	mm
436-7572	0.8-10	1/32-3/8	3/8-24UNF	41	54	64
436-7573	0.8-10	1/32-3/8	1/2-20UNF	41	54	64
436-7574	1.5-13	1/16-1/2	3/8-24UNF	42.5	62	75
436-7575	1.5-13	1/16-1/2	1/2-20UNF	42.5	62	75
436-7576	3.0-16	1/8-5/8	5/8-16UNF	50	71.5	86
436-7577	3.0-16	1/8-5/8	1/2-20UNF	50	71.5	86



# DRILL CHUCKS

## With lock system plastic shell chuck

Application: Recommended for impact electric drills up to 600-950W.

Features:

1. patented appearance with Human-based design, more comfortable and positive gripping can apply more output torque.
2. By using specialized anti-thrust bearing to convert hand-applied torque into superior gripping force.
3. patented positive lock system with "clack" feature indicating that the chuck is properly tightened, when rotate the front sleeve, which prevents loosening in hammer and other high-vibration applications.
4. Color and style can be made according to the customer's demands to match different drills.
5. Metal or plastic sleeves can be chosen according to the requirements.

Order No.	Capacity		Mount	Body Diameter	Length Between Ends	Length
	mm	Inch		mm	mm	mm
436-7578	1.5-13	1/16-1/2	3/8-24UNF	42.5	62	75
436-7579	1.5-13	1/16-1/2	1/2-20UNF	42.5	62	75



## With lock system plastic shell chuck

Application: Recommended for impact electric drills up to 600-950W.

Features:

1. patented appearance with Human-based design, more comfortable and positive gripping can apply more output torque.
2. By using specialized anti-thrust bearing to convert hand-applied torque into superior gripping force.
3. patented positive lock system with "clack" feature indicating that the chuck is properly tightened, when rotate the front sleeve, which prevents loosening in hammer and other high-vibration applications.
4. Color and style can be made according to the customer's demands to match different drills.
5. Metal or plastic sleeves can be chosen according to the requirements.

Order NO.	Capacity		Mount	Body Diameter	Length Between Ends	Length
	mm	Inch		mm	mm	mm
436-7580	0.8-10	1/16-3/8	3/8-24UNF	41	54	64
436-7581	0.8-10	1/16-3/8	1/2-20UNF	41	54	64
436-7582	1.5-13	1/16-1/2	3/8-24UNF	43	65	75
436-7583	1.5-13	1/16-1/2	1/2-20UNF	43	65	75



## With lock system plastic shell chuck

Application: Recommended for impact electric drills up to 600-950W.

Features:

1. patented appearance with Human-based design, more comfortable and positive gripping can apply more output torque.
2. By using specialized anti-thrust bearing to convert hand-applied torque into superior gripping force.
3. patented positive lock system with "clack" feature indicating that the chuck is properly tightened, when rotate the front sleeve, which prevents loosening in hammer and other high-vibration applications.
4. Color and style can be made according to the customer's demands to match different drills.
5. Metal or plastic sleeves can be chosen according to the requirements.

Order NO.	Capacity		Mount	Body Diameter	Length Between Ends	Length
	mm	Inch		mm	mm	mm
436-7584	0.8-10	1/32-3/8	3/8-24UNF	41	54	64
436-7585	0.8-10	1/32-3/8	1/2-20UNF	41	54	64
436-7586	1.5-13	1/16-1/2	3/8-24UNF	43	65	75
436-7587	1.5-13	1/16-1/2	1/2-20UNF	43	65	75



## With lock system plastic shell chuck

Application: Recommended for impact electric drills up to 600-950W.

Features:

1. patented appearance with Human-based design, more comfortable and positive gripping can apply more output torque.
2. By using specialized anti-thrust bearing to convert hand-applied torque into superior gripping force.
3. patented positive lock system with "clack" feature indicating that the chuck is properly tightened, when rotate the front sleeve, which prevents loosening in hammer and other high-vibration applications.
4. Color and style can be made according to the customer's demands to match different drills.
5. Metal or plastic sleeves can be chosen according to the requirements.

Order NO.	Capacity		Mount	Body Diameter	Length Between Ends	Length
	mm	Inch		mm	mm	mm
436-7588	0.8-10	1/32-3/8	3/8-24UNF	41	54	64
436-7589	0.8-10	1/32-3/8	1/2-20UNF	41	54	64
436-7590	1.5-13	1/16-1/2	3/8-24UNF	43	65	75
436-7591	1.5-13	1/16-1/2	1/2-20UNF	43	65	75



## With lock system plastic shell chuck

Application: Recommended for impact electric drills up to 600-950W.

Features:

1. patented appearance with Human-based design, more comfortable and positive gripping can apply more output torque.
2. By using specialized anti-thrust bearing to convert hand-applied torque into superior gripping force.
3. patented positive lock system with "clack" feature indicating that the chuck is properly tightened, when rotate the front sleeve, which prevents loosening in hammer and other high-vibration applications.
4. Color and style can be made according to the customer's demands to match different drills.
5. Metal or plastic sleeves can be chosen according to the requirements.

Order NO.	Capacity		Mount	Body Diameter	Length Between Ends	Length
	mm	Inch		mm	mm	mm
436-7592	0.8-10	1/32-3/8	3/8-24UNF	41	54	64
436-7593	0.8-10	1/32-3/8	1/2-20UNF	41	54	64
436-7594	1.5-13	1/16-1/2	3/8-24UNF	43	65	75
436-7595	1.5-13	1/16-1/2	1/2-20UNF	43	65	75



## With lock system plastic shell chuck

Application: Recommended for impact electric drills up to 600-950W.

Features:

1. patented appearance with Human-based design, more comfortable and positive gripping can apply more output torque.
2. By using specialized anti-thrust bearing to convert hand-applied torque into superior gripping force.
3. patented positive lock system with "clack" feature indicating that the chuck is properly tightened, when rotate the front sleeve, which prevents loosening in hammer and other high-vibration applications.
4. Color and style can be made according to the customer's demands to match different drills.
5. Metal or plastic sleeves can be chosen according to the requirements.

Order NO.	Capacity		Mount	Body Diameter	Length Between Ends	Length
	mm	Inch		mm	mm	mm
436-7596	0.8-10	1/32-3/8	3/8-24UNF	41	54	64
436-7597	0.8-10	1/32-3/8	1/2-20UNF	41	54	64
436-7598	1.5-13	1/16-1/2	3/8-24UNF	43	65	75
436-7599	1.5-13	1/16-1/2	1/2-20UNF	43	65	75



## With lock system plastic shell chuck

Application: Recommended for impact electric drills up to 600-950W.

Features;

- 1.patented appearance with Human-based design,more comtortable and positive gripping can apply more output torque.
- 2.By using specialized anti-thrust bearing to convert hand-applied torque into superior gripping force.
- 3.patented positive lock system with "clack" feature indicating that the chuck is properly tightened,when rotate the front sleeve,which prevents loosening in hammer and other high-vibration applications.
- 4.Color and style can be made according to the customer's demands to match different drills.
- 5.Metal or plastic sleeves can be chosen according to the requirements.

Order NO.	Capacity		Mount	Body Diameter	Length Between Ends	Length
	mm	Inch		mm	mm	mm
436-7600	0.8-10	1/32-3/8	3/8-24UNF	41	54	64
436-7601	0.8-10	1/32-3/8	1/2-20UNF	41	54	64
436-7602	1.5-13	1/16-1/2	3/8-24UNF	43	65	75
436-7603	1.5-13	1/16-1/2	1/2-20UNF	43	65	75



STYLE A

## With lock system plastic shell chuck

Application: Recommended for impact electric drills up to 600-950W.

Features:

- 1.patented appearance with Human-based design,more comtortable and positive gripping can apply more output torque.
- 2.By using specialized anti-thrust bearing to convert hand-applied torque into superior gripping force.
- 3.patented positive lock system with "clack" feature indicating that the chuck is properly tightened,when rotate the front sleeve,which prevents loosening in hammer and other high-vibration applications.
- 4.Color and style can be made according to the customer's demands to match different drills.
- 5.Metal or plastic sleeves can be chosen according to the requirements.

Order NO.	Capacity		Mount	Body Diameter	Length Between Ends	Length
	mm	Inch		mm	mm	mm
436-7604	0.8-10	1/32-3/8	3/8-24UNF	41	54	64
436-7605	0.8-10	1/32-3/8	1/2-20UNF	41	54	64
436-7606	1.5-13	1/16-1/2	3/8-24UNF	43	62	75
436-7607	1.5-13	1/16-1/2	1/2-20UNF	43	62	75



STYLE A

## With lock system plastic shell chuck

Application: Recommended for impact electric drills up to 600-950W.

Features:

- 1.patented appearance with Human-based design,more comtortable and positive gripping can apply more output torque.
- 2.By using specialized anti-thrust bearing to convert hand-applied torque into superior gripping force.
- 3.patented positive lock system with "clack" feature indicating that the chuck is properly tightened,when rotate the front sleeve,which prevents loosening in hammer and other high-vibration applications.
- 4.Color and style can be made according to the customer's demands to match different drills.
- 5.Metal or plastic sleeves can be chosen according to the requirements.

Order NO.	Capacity		Mount	Body Diameter	Length Between Ends	Length
	mm	Inch		mm	mm	mm
436-7608	0.8-10	1/32-1/2	3/8-24UNF	41	54	64
436-7609	0.8-10	1/32-1/2	1/2-20UNF	41	54	64
436-7610	1.5-13	1/16-1/2	3/8-24UNF	43	62	75
436-7611	1.5-13	1/16-1/2	1/2-20UNF	43	62	75





## With lock system plastic shell chuck

Application: Recommended for impact electric drills up to 600-950W.

Features:

1. patented appearance with Human-based design, more comfortable and positive gripping can apply more output torque.
2. By using specialized anti-thrust bearing to convert hand-applied torque into superior gripping force.
3. patented positive lock system with "clack" feature indicating that the chuck is properly tightened, when rotate the front sleeve, which prevents loosening in hammer and other high-vibration applications.
4. Color and style can be made according to the customer's demands to match different drills.
5. Metal or plastic sleeves can be chosen according to the requirements.

Order No.	Capacity		Mount	Body Diameter	Length Between Ends	Length
	mm	Inch		mm	mm	mm
436-7612	0.8-10	1/32-3/8	3/8-24UNF	41	54	64
436-7613	0.8-10	1/32-3/8	1/2-20UNF	41	54	64
436-7614	1.5-13	1/16-1/2	3/8-24UNF	43	62	75
436-7615	1.5-13	1/16-1/2	1/2-20UNF	43	62	75



## With lock system plastic shell chuck

Application: Recommended for impact electric drills up to 600-950W.

Features:

1. patented appearance with Human-based design, more comfortable and positive gripping can apply more output torque.
2. By using specialized anti-thrust bearing to convert hand-applied torque into superior gripping force.
3. patented positive lock system with "clack" feature indicating that the chuck is properly tightened, when rotate the front sleeve, which prevents loosening in hammer and other high-vibration applications.
4. Color and style can be made according to the customer's demands to match different drills.
5. Metal or plastic sleeves can be chosen according to the requirements.



STYLE A



STYLE B

Order NO.	Capacity		Mount	Body Diameter	Length Between Ends	Length
	mm	Inch		mm	mm	mm
436-7616	1.5-13	1/16-1/2	3/8-24UNF	46	69	83
436-7617	1.5-13	1/16-1/2	1/2-20UNF	46	69	83

## With lock system plastic shell chuck

Application: Recommended for impact electric drills up to 600-950W.

Features:

1. patented appearance with Human-based design, more comfortable and positive gripping can apply more output torque.
2. By using specialized anti-thrust bearing to convert hand-applied torque into superior gripping force.
3. patented positive lock system with "clack" feature indicating that the chuck is properly tightened, when rotate the front sleeve, which prevents loosening in hammer and other high-vibration applications.
4. Color and style can be made according to the customer's demands to match different drills.
5. Metal or plastic sleeves can be chosen according to the requirements.



STYLE B



STYLE A

Order NO.	Capacity		Mount	Body Diameter	Length Between Ends	Length
	mm	Inch		mm	mm	mm
436-7618	1.5-13	1/16-1/2	3/8-24UNF	46	69	83
436-7619	1.5-13	1/16-1/2	1/2-20UNF	46	69	83

## With lock system plastic shell chuck

Application: Recommended for impact electric drills up to 600-950W.

Features:

1. patented appearance with Human-based design, more comfortable and positive gripping can apply more output torque.
2. By using specialized anti-thrust bearing to convert hand-applied torque into superior gripping force.
3. patented positive lock system with "clack" feature indicating that the chuck is properly tightened, when rotate the front sleeve, which prevents loosening in hammer and other high-vibration applications.
4. Color and style can be made according to the customer's demands to match different drills.
5. Metal or plastic sleeves can be chosen according to the requirements.



Order NO.	Capacity		Mount	Body Diameter	Length Between Ends	Length
	mm	Inch		mm	mm	mm
436-7620	1.5-13	1/16-1/2	3/8-24UNF	43	68	80
436-7621	1.5-13	1/16-1/2	1/2-20UNF	43	68	80

## Keyless chuck Without lock system

Application: Recommended for DIY user, Professional AC&DC, Pneumatic drill machines.

Features:

1. patented appearance with Human-based design, more comfortable and positive gripping can apply more output torque
2. By using specialized anti-thrust bearing to convert hand-applied torque into superior gripping force.
3. patented unsmoothly design, front sleeve cooperated with rear sleeve to reduce sleeve shaking.
4. Color and style can be made according to the customer's demands to match different drills.
5. Metal or plastic sleeves can be chosen according to the requirements.



Order NO.	Capacity		Mount	Body Diameter	Length Between Ends	Length
	mm	Inch		mm	mm	mm
436-7622	1.0-10	1/32-3/8	3/8-24UNF	41	55	64
436-7623	1.0-10	1/32-3/8	1/2-20UNF	41	55	64

## Keyless chuck Without lock system

Application: Recommended for DIY user, Professional AC&DC, Pneumatic drill machines.

Features;

1. patented appearance with Human-based design, more comfortable and positive gripping can apply more output torque
2. By using specialized anti-thrust bearing to convert hand-applied torque into superior gripping force.
3. patented unsmoothly design, front sleeve cooperated with rear sleeve to reduce sleeve shaking.
4. Color and style can be made according to the customer's demands to match different drills.
5. Metal or plastic sleeves can be chosen according to the requirements.



Order NO.	Capacity		Mount	Body Diameter	Length Between Ends	Length
	mm	Inch		mm	mm	mm
436-7624	0.6-6	1/64-1/4	3/8-24UNF	38.5	45.5	54
436-7625	0.8-10	1/32-3/8	3/8-24UNF	38.5	45.5	54

## Keyless chuck Without lock system

Application: Recommended for DIY user, Professional AC&DC, Pneumatic drill machines.

Feature:

1. Patented appearance with Human-based design, more comfortable and positive gripping can apply more output torque
2. By using specialized anti-thrust bearing to convert hand-applied torque into superior gripping force.
3. Patented unsmoothly design, front sleeve cooperated with rear sleeve to reduce sleeve shaking.
4. Color and style can be made according to the customer's demands to match different drills.
5. Metal or plastic sleeves can be chosen according to the requirements.

Order NO.	Capacity		Mount	Body Diameter	Length Between Ends	Length
	mm	Inch		mm	mm	mm
436-7626	0.8-10	1/32-3/8	3/8-24UNF	43	54	65
436-7627	0.8-10	1/32-3/8	1/2-20UNF	43	54	65
436-7628	1.5-13	1/16-1/2	3/8-24UNF	43	62.3	75.5
436-7629	1.5-13	1/16-1/2	1/2-20UNF	43	62.3	75.5



STYLE B



STYLE A

## Keyless chuck Without lock system

Application: Recommended for DIY user, Professional AC&DC, Pneumatic drill machines.

Features:

1. Patented appearance with Human-based design, more comfortable and positive gripping can apply more output torque
2. By using specialized anti-thrust bearing to convert hand-applied torque into superior gripping force.
3. Patented unsmoothly design, front sleeve cooperated with rear sleeve to reduce sleeve shaking.
4. Color and style can be made according to the customer's demands to match different drills.
5. Metal or plastic sleeves can be chosen according to the requirements.

Order NO.	Capacity		Mount	Body Diameter	Length Between Ends	Length
	mm	Inch		mm	mm	mm
436-7630	0.8-10	1/32-3/8	3/8-24UNF	38	51.5	62
436-7631	0.8-10	1/32-3/8	1/2-20UNF	38	51.5	62



## Keyless chuck Without lock system

Application: Recommended for DIY user, Professional AC&DC, Pneumatic drill machines.

Features:

1. Patented appearance with Human-based design, more comfortable and positive gripping can apply more output torque
2. By using specialized anti-thrust bearing to convert hand-applied torque into superior gripping force.
3. Patented unsmoothly design, front sleeve cooperated with rear sleeve to reduce sleeve shaking.
4. Color and style can be made according to the customer's demands to match different drills.
5. Metal or plastic sleeves can be chosen according to the requirements.

Order NO.	Capacity		Mount	Body Diameter	Length Between Ends	Length
	mm	Inch		mm	mm	mm
436-7632	0.8-10	1/32-3/8	3/8-24UNF	45	55	65
436-7633	0.8-10	1/32-3/8	1/2-20UNF	45	55	65



STYLE B



STYLE A

# DRILL CHUCKS

## Keyless chuck Without lock system

Application: Recommended for DIY user, Professional AC&DC, Pneumatic drill machines.

Features:

1. patented appearance with Human-based design, more comfortable and positive gripping can apply more output torque
2. By using specialized anti-thrust bearing to convert hand-applied torque into superior gripping force.
3. patented unsmoothly design, front sleeve cooperate with rear sleeve to reduce sleeve shaking.
4. Color and style can be made according to the customer's demands to match different drills.
5. Metal or plastic sleeves can be chosen according to the requirements.

Order No.	Capacity		Mount	Body Diameter	Length Between Ends	Length
	mm	Inch		mm	mm	mm
436-7634	0.8-10	1/32-3/8	3/8-24UNF	45	55	65
436-7635	0.8-10	1/32-3/8	1/2-20UNF	45	55	65



## Keyless chuck Without lock system

Application: Recommended for DIY user, Professional AC&DC, Pneumatic drill machines.

Features:

1. patented appearance with Human-based design, more comfortable and positive gripping can apply more torque
2. By using specialized anti-thrust bearing to convert hand-applied torque into superior gripping force.
3. patented unsmoothly design, front sleeve cooperate with rear sleeve to reduce sleeve shaking.
4. Color and style can be made according to the customer's demands to match different drills.
5. Metal or plastic sleeves can be chosen according to the requirements.



Order NO.	Capacity		Mount	Body Diameter	Length Between Ends	Length
	mm	Inch		mm	mm	mm
436-7636	0.8-10	1/32-3/8	3/8-24UNF	45	55	65
436-7637	0.8-10	1/32-3/8	1/2-20UNF	45	55	65

## Keyless chuck Without lock system

Application: Recommended for DIY user, Professional AC&DC, Pneumatic drill machines.

Features:

1. patented appearance with Human-based design, more comfortable and positive gripping can apply more output torque
2. By using specialized anti-thrust bearing to convert hand-applied torque into superior gripping force.
3. patented unsmoothly design, front sleeve cooperate with rear sleeve to reduce sleeve shaking.
4. Color and style can be made according to the customer's demands to match different drills.
5. Metal or plastic sleeves can be chosen according to the requirements.



Order No.	Capacity		Mount	Body Diameter	Length Between Ends	Length
	mm	Inch		mm	mm	mm
436-7638	0.8-10	1/32-3/8	3/8-24UNF	39	50	60
436-7639	0.8-10	1/32-3/8	1/2-20UNF	39	50	60
436-7640	1.5-13	1/16-1/2	3/8-24UNF	41	61	74
436-7641	1.5-13	1/16-1/2	1/2-20UNF	41	61	74



## Keyless chuck Without lock system

Application: Recommended for DIY user, Professional AC&DC, Pneumatic drill machines.

Features:

1. patented appearance with Human-based design, more comfortable and positive gripping can apply more output torque
2. By using specialized anti-thrust bearing to convert hand-applied torque into superior gripping force.
3. patented unsmoothly design, front sleeve cooperated with rear sleeve to reduce sleeve shaking.
4. Color and style can be made according to the customer's demands to match different drills.
5. Metal or plastic sleeves can be chosen according to the requirements

Order NO.	Capacity		Mount	Body Diameter	Length Between Ends	Length
	mm	Inch		mm	mm	mm
436-7642	0.8-10	1/32-3/8	3/8-24UNF	43	54	64.5
436-7643	0.8-10	1/32-3/8	1/2-20UNF	43	54	64.5
436-7644	1.5-13	1/16-1/2	3/8-24UNF	43	62	75
436-7645	1.5-13	1/16-1/2	1/2-20UNF	43	62	75



STYLE A



STYLE A

## Keyless chuck Without lock system

Application: Recommended for DIY user, Professional AC&DC, Pneumatic drill machines.

Features:

1. patented appearance with Human-based design, more comfortable and positive gripping can apply more output torque
2. By using specialized anti-thrust bearing to convert hand-applied torque into superior gripping force.
3. patented unsmoothly design, front sleeve cooperated with rear sleeve to reduce sleeve shaking.
4. Color and style can be made according to the customer's demands to match different drills.
5. Metal or plastic sleeves can be chosen according to the requirements

Order NO.	Capacity		Mount	Body Diameter	Length Between Ends	Length
	mm	Inch		mm	mm	mm
436-7646	0.8-10	1/32-3/8	3/8-24UNF	41	54.5	64
436-7647	0.8-10	1/32-1/8	1/2-20UNF	41	54.5	64
436-7648	1.5-13	1/16-1/2	3/8-24UNF	43	62	74.5
436-7649	1.5-13	1/16-1/2	1/2-20UNF	43	62	74.5



STYLE A



STYLE B

## Keyless chuck Without lock system

Application: Recommended for DIY user, Professional AC&DC, Pneumatic drill machines.

Features:

1. patented appearance with Human-based design, more comfortable and positive gripping can apply more output torque
2. By using specialized anti-thrust bearing to convert hand-applied torque into superior gripping force.
3. patented unsmoothly design, front sleeve cooperated with rear sleeve to reduce sleeve shaking.
4. Color and style can be made according to the customer's demands to match different drills.
5. Metal or plastic sleeves can be chosen according to the requirements.

Order NO.	Capacity		Mount	Body Diameter	Length Between Ends	Length
	mm	Inch		mm	mm	mm
436-7650	0.8-10	1/32-3/8	3/8-24UNF	43	54	65
436-7651	0.8-10	1/32-3/8	1/2-20UNF	43	54	65
436-7652	1.5-13	1/16-1/2	3/8-24UNF	45	62	75
436-7653	1.5-13	1/16-1/2	1/2-20UNF	45	62	75
436-7654	0.8-10	1/32-3/8	3/8-24UNF	43	54	65
436-7655	0.8-10	1/32-3/8	1/2-20UNF	43	54	65
436-7656	1.5-13	1/16-1/2	3/8-24UNF	45	62	75
436-7657	1.5-13	1/16-1/2	1/2-20UNF	45	62	75



# DRILL CHUCKS

## Keyless chuck Without lock system

Application: Recommended for DIY user, Professional AC&DC, Pneumatic drill machines.

Features

1. patented appearance with Human-based design, more comfortable and positive gripping can apply more output torque
2. By using specialized anti-thrust bearing to convert hand-applied torque into superior gripping force.
3. patented unsmoothly design, front sleeve cooperate with rear sleeve to reduce sleeve shaking.
4. Color and style can be made according to the customer's demands to match different drills.
5. Metal or plastic sleeves can be chosen according to the requirements.



STYLE A



STYLE B



STYLE C

Order NO.	Capacity		Mount	Body Diameter	Length Between Ends	Length
	mm	Inch		mm	mm	mm
436-7658	0.8-10	1/32-3/8	3/8-24UNF	45	55	65
436-7659	0.8-10	1/32-3/8	1/2-20UNF	45	55	65

## Keyless chuck Without lock system

Application: Recommended for DIY user, Professional AC&DC, Pneumatic drill machines.

Features

1. patented appearance with Human-based design, more comfortable and positive gripping can apply more output torque
2. By using specialized anti-thrust bearing to convert hand-applied torque into superior gripping force.
3. patented unsmoothly design, front sleeve cooperate with rear sleeve to reduce sleeve shaking.
4. Color and style can be made according to the customer's demands to match different drills.
5. Metal or plastic sleeves can be chosen according to the requirements.

Order NO.	Capacity		Mount	Body Diameter	Length Between Ends	Length
	mm	Inch		mm	mm	mm
436-7660	0.8-10	1/32-3/8	3/8-24UNF	43	54	65
436-7661	0.8-10	1/32-3/8	1/2-20UNF	43	54	65
436-7662	1.5-13	1/16-1/2	3/8-24UNF	45	62	75
436-7663	1.5-13	1/16-1/2	1/2-20UNF	45	62	75
436-7664	0.8-10	1/32-3/8	3/8-24UNF	43	54	65
436-7665	0.8-10	1/32-3/8	1/2-20UNF	43	54	65
436-7666	1.5-13	1/16-1/2	3/8-24UNF	45	62	75
436-7667	1.5-13	1/16-1/2	1/2-20UNF	45	62	75



## Keyless chuck Without lock system



STYLE A



STYLE C



STYLE B

Order NO.	Model	Capacity		Mount	Body Diameter	Length Between Ends	Length
		mm	Inch		mm	mm	mm
436-7668	J1510P	0.8-10	1/32-3/8	3/8-24UNF	45	55	65
436-7669	J1510P	0.8-10	1/32-3/8	1/2-20UNF	45	55	65

## Keyless chuck Without lock system

Application: Recommended for DIY user, Professional AC&DC, Pneumatic drill machines.

Features:

1. patented appearance with Human-based design, more comfortable and positive gripping can apply more output torque
2. By using specialized anti-thrust bearing to convert hand-applied torque into superior gripping force.
3. patented unsmoothly design, front sleeve cooperated with rear sleeve to reduce sleeve shaking.
4. Color and style can be made according to the customer's demands to match different drills.
5. Metal or plastic sleeves can be chosen according to the requirements.

Order NO.	Capacity		Mount	Body Diameter	Length Between Ends	Length
	mm	Inch		mm	mm	mm
436-7670	0.8-10	1/32-3/8	3/8-24UNF	43	54	65
436-7671	0.8-10	1/32-3/8	1/2-20UNF	43	54	65
436-7672	1.5-13	1/16-1/2	3/8-24UNF	43	62	75
436-7673	1.5-13	1/16-1/2	1/2-20UNF	43	62	75



## Keyless chuck Without lock system

Application: Recommended for DIY user, Professional AC&DC, Pneumatic drill machines.

Features:

1. patented appearance with Human-based design, more comfortable and positive gripping can apply more output torque
2. By using specialized anti-thrust bearing to convert hand-applied torque into superior gripping force.
3. patented unsmoothly design, front sleeve cooperated with rear sleeve to reduce sleeve shaking.
4. Color and style can be made according to the customer's demands to match different drills.
5. Metal or plastic sleeves can be chosen according to the requirements.

Order No.	Capacity		Mount	Body Diameter	Length Between Ends	Length
	mm	Inch		mm	mm	mm
436-7674	0.8-10	1/32-3/8	3/8-24UNF	43	54	64.5
436-7675	0.8-10	1/32-3/8	1/2-20UNF	43	54	64.5
436-7676	1.5-13	1/16-1/2	3/8-24UNF	43	62	75
436-7677	1.5-13	1/16-1/2	1/2-20UNF	43	62	75



## Keyless chuck Without lock system

Application: Recommended for DIY user, Professional AC&DC, Pneumatic drill machines.

Features:

1. patented appearance with Human-based design, more comfortable and positive gripping can apply more output torque
2. By using specialized anti-thrust bearing to convert hand-applied torque into superior gripping force.
3. patented unsmoothly design, front sleeve cooperated with rear sleeve to reduce sleeve shaking.
4. Color and style can be made according to the customer's demands to match different drills.
5. Metal or plastic sleeves can be chosen according to the requirements.

Order NO.	Capacity		Mount	Body Diameter	Length Between Ends	Length
	mm	Inch		mm	mm	mm
436-7678	2.0-13	1/16-1/2	3/8-24UNF	43	62	75.4
436-7679	2.0-13	1/16-1/2	1/2-20UNF	43	62	75.4



# DRILL CHUCKS

## Keyless chuck Without lock system

Application: Recommended for impact electric drills up to 600-950W.

Features:

1. patented appearance with Human-based design, more comfortable and positive gripping can apply more output torque.
2. By using specialized anti-thrust bearing to convert hand-applied torque into superior gripping force.
3. patented positive lock system with "clack" feature indicating that the chuck is properly tightened, when rotate the front sleeve, which prevents loosening in hammer and other high-vibration applications.
4. Color and style can be made according to the customer's demands to match different drills.
5. Metal or plastic sleeves can be chosen according to the requirements.

Order No.	Capacity		Mount	Body Diameter	Length Between Ends	Length
	mm	Inch		mm	mm	mm
436-7680	2.0-13	1/16-1/2	1/2-20UNF	43	62	75
436-7681	2.0-13	1/16-1/2	3/8-24UNF	43	62	75



## Keyless chuck Without lock system

Application: Recommended for DIY user, Professional AC&DC, Pneumatic drill machines.

Features:

1. patented appearance with Human-based design, more comfortable and positive gripping can apply more output torque
2. By using specialized anti-thrust bearing to convert hand-applied torque into superior gripping force.
3. patented unsmoothly design, front sleeve cooperated with rear sleeve to reduce sleeve shaking.
4. Color and style can be made according to the customer's demands to match different drills.
5. Metal or plastic sleeves can be chosen according to the requirements.

Order NO.	Capacity		Mount	Body Diameter	Length Between Ends	Length
	mm	Inch		mm	mm	mm
436-7682	1.5-13	1/16-1/2	1/2-20UNF	42.5	62	75
436-7683	1.5-13	1/16-1/2	3/8-24UNF	42.5	62	75



## Industrial keyed chuck

Features

- \* High precision threaded and tapered tightly mounts on the tools.
- \* Sleeve, Key hole and key are shaped by quenching.
- \* Jaws are specifically engineered for tight tolerance production drilling.
- \* Sleeve tech and keyholes are shaped by cold pressing.
- \* Harvest patented anti-hitting design prevent three holes of the body from damage in the drilling.
- \* Super precision and durable.
- \* Harvest Patented thumb grip styles with human-based design increase leverage and user comfort.



Order No.	Capacity		Mount	D	L1	L
	mm	Inch		mm	mm	mm
436-7396	0.6-6	1/64-1/4	B10	30.3	39.5	50
436-7397	1.0-10	1/32-3/8	B12	43.4	54	69.7
436-7398	1.0-13	1/32-1/2	B16	53.2	67	86
436-7399	1.0-16	1/32-5/8	B16	57	75	93
436-7400	1.0-16	1/32-5/8	B18	57	75	93
436-7401	5.0-20	3/16-3/4	B22	65.3	82	110
436-7402	0.6-6	1/64-1/4	JT1	30.3	39.5	50
436-7403	1.0-10	1/32-3/8	JT2	43.4	54	69.7
436-7404	1.0-13	1/32-1/2	JT33	53.2	67	86
436-7405	1.0-13	1/32-1/2	JT6	53.2	67	86
436-7406	1.0-16	1/32-5/8	JT3	57	75	93
436-7407	1.0-19	1/32-3/4	JT4	65.3	82	110
436-7408	5.0-20	3/16-3/4	JT3	68	92	120



## Keyed chuck with lock system

### Features

- \* Ideal products for impact drills, featured with pre-tighten function on the rear sleeve with positive lock system.
- \* Positive lock system with "clack" feature indicating that the chuck is properly tightened when rotate the rear sleeve, which prevents loosening in hammer and other high-vibration applications.
- \* Jaw, nut, and key are specifically engineered for tight tolerance production drilling by quenching, for greater durability and extended life.
- \* **Recommended for impact electric drills up to 1100W.**

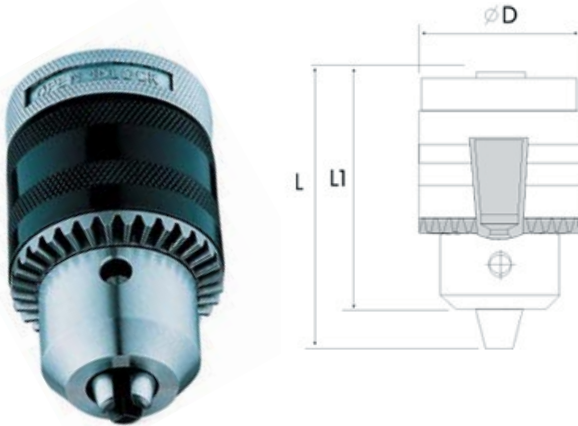

Order No.	Capacity		Mount	D	L1	L
	mm	Inch		mm	mm	mm
436-7409	1.5-10	1/16-3/8	3/8-24UNF	43.4	65	81
436-7410	1.5-10	1/16-1/2	1/2-20UNF	43.4	65	81
436-7411	1.5-13	1/16-1/2	1/2-20UNF	53.2	78	97
436-7412	1.5-10	1/16-3/8	B12	43.4	65	81
436-7413	1.5-13	1/16-1/2	B16	53.2	78	97
436-7414	3.0-16	1/8-5/8	B16	53.2	78	97
436-7415	3.0-16	1/8-5/8	B18	53.2	78	97
436-7416	1.5-10	1/16-3/8	JT2	43.4	65	81
436-7417	1.5-13	1/16-1/2	JT33	53.2	78	97
436-7418	1.5-13	1/16-1/2	JT6	53.2	78	97
436-7419	3.0-16	1/8-5/8	JT3	53.2	78	97
436-7420	3.0-16	1/8-5/8	JT33	53.2	78	97
436-7421	3.0-16	1/8-5/8	JT6	53.2	78	97

## Keyed chuck without lock system

### Features:

- \* High precision threaded and tapered tightly mounts on the tools.
- \* It can be protected from rusting for Cr-coated body and good appearance with sleeve electrophoretic enamelling.
- \* By using specialized anti-thrust bearing to convert key-applied torque into superior gripping and anti bounce force.
- \* Jaws are specifically engineered for tight tolerance production drilling.
- \* Super precision and durable.
- \* Recommended for impact electric drills and kinds of AC&DC electric drill.

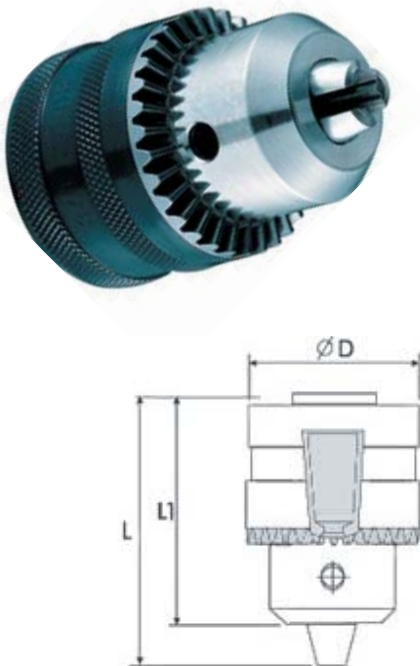

Order No.	Capacity		Mount	D	L1	L
	mm	Inch		mm	mm	mm
436-7422	0.6-6	1/64-1/4	3/8-24UNF	30.3	40	49
436-7423	1.5-10	1/16-3/8	3/8-24UNF	34	49	58.5
436-7424	1.5-10	1/16-3/8	1/2-20UNF	34	49	58.5
436-7425	1.5-10	1/16-3/8	M10×1.0	34	49	58.5
436-7426	1.5-10	1/16-3/8	M12×1.25	34	49	58.5
436-7427	1.5-13	1/16-1/2	3/8-24UNF	42	59	71.5
436-7428	1.5-13	1/16-1/2	1/2-20UNF	42	59	71.5
436-7429	1.5-13	1/16-1/2	M12×1.0	42	59	71.5
436-7430	1.5-13	1/16-1/2	M12×1.25	42	59	71.5
436-7431	1.5-13	1/16-1/2	M14×1.0	42	59	71.5
436-7432	3.0-16	1/8-5/8	3/8-24UNF	52	67	86
436-7433	3.0-16	1/8-5/8	1/2-20UNF	52	67	86
436-7434	3.0-16	1/8-5/8	5/8-16UNF	52	67	86
436-7435	3.0-16	1/8-5/8	M12×1.25	52	67	86
436-7436	0.6-6	1/64-1/4	B10	30.3	40	49
436-7437	1.5-10	1/16-3/8	B12	34	49	58.5
436-7438	1.5-13	1/16-1/2	B16	42	59	71.5
436-7439	3.0-16	1/8-5/8	B16	52	67	86
436-7440	3.0-16	1/8-5/8	B18	52	67	86

# DRILL CHUCKS

## Keyed chuck without lock system

### Features:

- \* High precision threaded and tapered tightly mounts on the tools.
- \* Jaw are specifically engineered for tight tolerance production drilling.
- \* Super precision and durable.
- \* Recommended for impact electric drills and kinds of AC&DC electric drill.

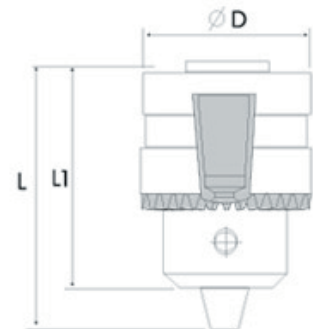

Order No.	Capacity		Mount	D	L1	L
	mm	Inch		mm	mm	mm
436-7441	0.6-6	1/64-1/4	3/8-24UNF	30.3	40	49
436-7442	1.5-10	1/16-3/8	3/8-24UNF	34	49	58.5
436-7443	1.5-10	1/16-3/8	1/2-20UNF	34	49	58.5
436-7444	1.5-10	1/16-3/8	M10X1.0	34	49	58.5
436-7445	1.5-10	1/16-3/8	M12X1.25	34	49	58.5
436-7446	0.6-6	1/64-1/4	B10	30.3	49	49
436-7447	1.5-10	1/16-3/8	B12	34	49	58.5
436-7448	0.6-6	1/64-1/4	JT1	30.3	40	49
436-7449	1.5-10	1/16-3/8	JT2	34	49	58.5

## Keyed chuck without lock system

Application: Recommended for impact electric drills and kinds of AC&DC electric drill.

### Features;

- \* High precision threaded and tapered tightly mounts on the tools.
- \* Jaw are specifically engineered for tight tolerance production drilling.
- \* Super precision and durable.

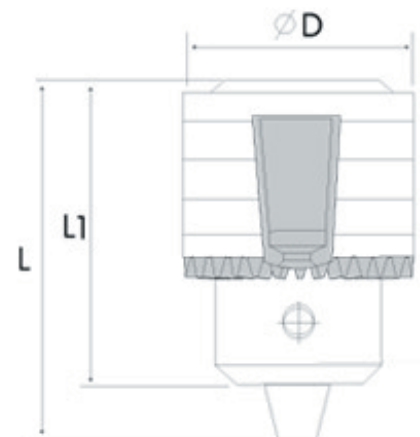

Order NO.	Capacity		Mount	D	L1	L
	mm	Inch		mm	mm	mm
436-7450	1.5-13	1/16-1/2	3/8-24UNF	42	59	71.5
436-7451	1.5-13	1/16-1/2	1/2-20UNF	42	59	71.5
436-7452	1.5-13	1/16-1/2	M12X1.0	42	59	71.5
436-7453	1.5-13	1/16-1/2	M12X1.25	42	59	71.5
436-7454	1.5-13	1/16-1/2	M14X1.0	42	59	71.5
436-7455	3.0-16	1/8-5/8	3/8-24UNF	52	67	86
436-7456	3.0-16	1/8-5/8	1/2-20UNF	52	67	86
436-7457	3.0-16	1/8-5/8	5/8-16UNF	52	67	86
436-7458	3.0-16	1/8-5/8	M12X1.25	52	67	86
436-7459	1.5-13	1/16-1/2	B16	42	59	71.5
436-7460	3.0-6	1/8-5/8	B16	52	67	86
436-7461	3.0-6	1/8-5/8	B18	52	67	86
436-7462	1.5-13	1/16-1/2	JT33	42	59	71.5

## Keyed chuck without lock system

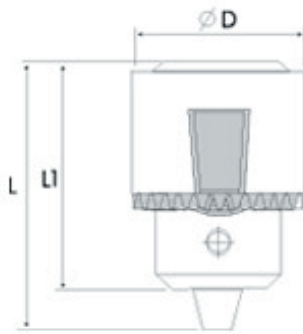

Order No.	Capacity		Mount	D mm	L1 mm	L mm
	mm	Inch				
436-7463	0.4-6	1/64-1/4	B10	30	40	49
436-7464	0.3-4	1/88-1/6	JT0	20	30	36

Application: Suitable for super electric grinder, engraving machine and precision machine lathe

## Keyed chuck without lock system

### Application

Recommended for impact electric drills and kinds of AC&DC electric drill.

### Features

- \* High precision threaded and tapered tightly mounts on the tools.
- \* This product is designed according to the DIN 6349.
- \* By using specialized anti-thrust bearing to convert key-applied torque into superior gripping and anti bounce force.
- \* Jaws are specifically engineered for tight tolerance production drilling.
- \* Super precision and durable.

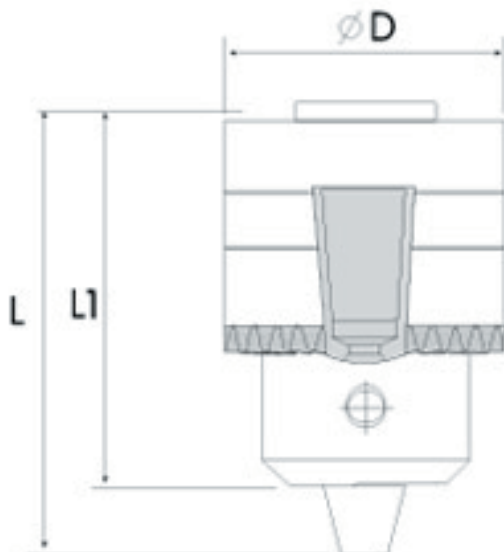

Order No.	Capacity		Mount	D mm	L1 mm	L mm
	mm	Inch				
436-7465	0.6-6	1/64-1/4	3/8-24UNF	30.3	40	49
436-7466	1.5-10	1/16-3/8	3/8-24UNF	34	49	58.5
436-7467	1.5-10	1/16-3/8	1/2-20UNF	34	49	58.5
436-7468	1.5-10	1/16-3/8	M10×1.0	34	49	58.5
436-7469	1.5-10	1/16-3/8	M12×1.25	34	49	58.5
436-7470	1.5-13	1/16-1/2	3/8-24UNF	42	59	71.5
436-7471	1.5-13	1/16-1/2	1/2-20UNF	42	59	71.5
436-7472	1.5-13	1/16-1/2	M12×1.0	42	59	71.5
436-7473	1.5-13	1/16-1/2	M12×1.25	42	59	71.5
436-7474	1.5-13	1/16-1/2	M14×1.0	42	59	71.5
436-7475	3.0-16	1/8-5/8	3/8-24UNF	52	67	86
436-7476	3.0-16	1/8-5/8	1/2-20UNF	52	67	86
436-7477	3.0-16	1/8-5/8	5/8-16UNF	52	67	86
436-7478	3.0-16	1/8-5/8	M12×1.25	52	67	86
436-7479	0.6-6	1/64-1/4	B10	30.3	40	49
436-7480	1.5-10	1/16-3/8	B12	34	49	58.5
436-7481	1.5-13	1/16-1/2	B16	42	59	71.5
436-7482	3.0-16	1/8-5/8	B16	52	67	86
436-7483	3.0-16	1/8-5/8	B18	52	67	86
436-7479	0.6-6	1/64-1/4	B10	30.3	40	49
436-7480	1.5-10	1/16-3/8	B12	34	49	58.5
436-7481	1.5-13	1/16-1/2	B16	42	59	71.5
436-7482	3.0-16	1/8-5/8	B16	52	67	86
436-7483	3.0-16	1/8-5/8	B18	52	67	86
436-7484	0.6-6	1/64-1/4	JT1	30.3	40	49
436-7485	1.5-10	1/16-3/8	JT2	34	49	58.5
436-7486	1.5-13					

## Keyed chuck without lock system

Application: Recommended for impact electric drills and kinds of AC&DC electric drill.

### Features:

- \* High precision threaded and tapered tightly mounts on the tools.
- \* Jaws are specifically engineered for tight tolerance production drilling.
- \* Super precision and durable.

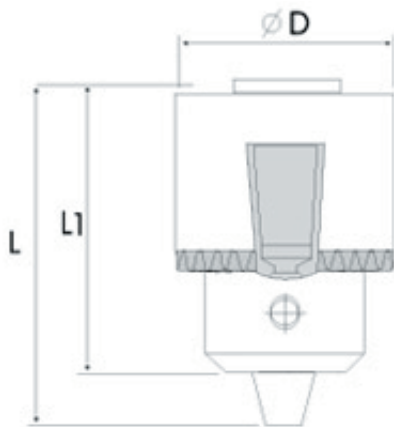

Art.No	Capacity		Mount	D	L1	L
	mm	Inch				
436-7487	0.6-6	1/16-1/4	3/8-24UNF	30.3	49	49
436-7488	1.5-10	1/16-3/8	3/8-24UNF	34	49	58.5
436-7489	1.5-10	1/16-3/8	1/2-20UNF	34	49	58.5
436-7490	1.5-10	1/16-3/8	M10×1.0	34	49	58.5
436-7491	1.5-10	1/16-3/8	M12×1.25	34	49	58.5
436-7492	1.5-13	1/16-1/2	3/8-24UNF	42	59	71.5
436-7493	1.5-13	1/16-1/2	1/2-20UNF	42	59	71.5
436-7494	1.5-13	1/16-1/2	M12×1.0	42	59	71.5
436-7495	1.5-13	1/16-1/2	M12×1.25	42	59	71.5
436-7496	1.5-13	1/16-1/2	M14×1.0	42	59	71.5
436-7497	3.0-16	1/8-5/8	3/8-24UNF	52	67	86
436-7498	3.0-16	1/8-5/8	1/2-20UNF	52	67	86
436-7499	3.0-16	1/8-5/8	5/8-16UNF	52	67	86
436-7500	3.0-16	1/8-5/8	M12×1.25	52	67	86
436-7501	0.6-6	1/64-1/4	B10	30.3	40	49
436-7502	1.5-10	1/16-3/8	B12	34	49	58.5
436-7503	1.5-13	1/16-1/2	B16	42	59	71.5
436-7504	3.0-16	1/8-5/8	B16	52	67	86
436-7505	3.0-10	1/8-5/8	B18	52	67	86
436-7506	0.6-6	1/64-1/4	JT1	30.3	40	49
436-7507	1.5-10	1/16-3/8	JT2	34	49	58.5
436-7508	1.5-13	1/16-1/2	JT33	42	59	71.5

## Keyed chuck without lock system

Application; Recommended for impact electric drills and kinds of AC&DC electric drill.

### Features:

- \* High precision threaded and tapered tightly mounts on the tools.
- \* Jaw are specifically engineered for tight tolerance production drilling.
- \* Super precision and durable.

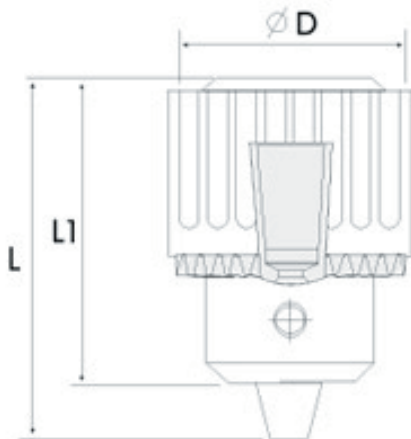

Order NO.	Capacity		Mount	D	L1	L
	mm	Inch				
436-7509	1.5-10	1/16-3/8	1/2-20UNF	39	49	59.6
436-7510	1.5-10	1/16-3/8	3/8-24UNF	39	49	59.6
436-7511	1.5-13	1/16-1/2	3/8-24UNF	43	62	75
436-7512	1.5-13	1/16-1/2	1/2-20UNF	43	62	75

## Threaded chuck without lock system



STYLE A



STYLE B

Application: Recommended for impact electric drills and kinds of AC&DC electric drill.

**Features:**

- \* High precision threaded and tapered tightly mounts on the tools.
- \* It can be protected from rusting for Cr-coated body and good appearance with sleeve electrophoretic enamelling.
- \* Jaws are specifically engineered for tight tolerance production drilling.
- \* Super precision and durable.

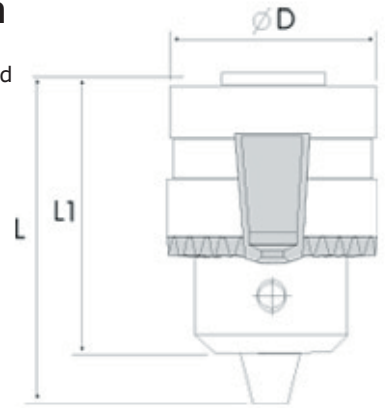

Order NO.	Capacity		Mount	D	L1	L
	mm	Inch		mm	mm	mm
436-7513	0.6-6	1/64-1/4	3/8-24UNF	30.3	40	49
436-7514	1.5-10	1/16-3/8	3/8-24UNF	34	49	58.5
436-7515	1.5-10	1/16-3/8	1/2-20UNF	34	49	58.5
436-7516	1.5-10	1/16-3/8	M12X1.25	34	49	58.5
436-7517	1.5-13	1/16-1/2	3/8-24UNF	42	59	71.5
436-7518	1.5-13	1/16-1/2	1/2-20UNF	42	59	71.5
436-7519	1.5-13	1/16-1/2	M12X1.25	42	59	71.5

## Keyed chuck without lock system



Application: Recommended for impact electric drills and kinds of AC&DC electric drill.

**Features:**

- \* High precision threaded and tapered tightly mounts on the tools.
- \* It can be protected from rusting for Cr-coated body and good appearance with sleeve electrophoretic enamelling.
- \* Jaws are specifically engineered for tight tolerance production drilling.
- \* Super precision and durable.

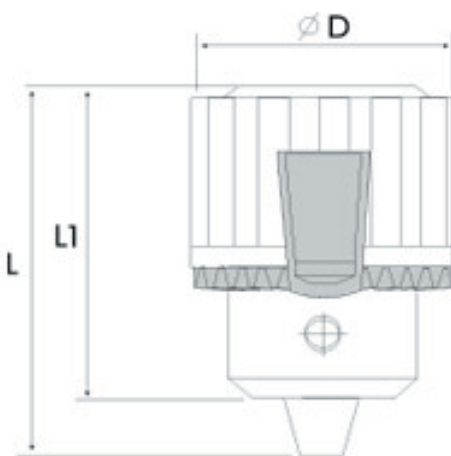

Order NO.	Capacity		Mount	D	L1	L
	mm	Inch		mm	mm	mm
436-7520	0.6-6	1/64-1/4	3/8-24UNF	30.3	40	49
436-7521	1.0-10	1/32-3/8	3/8-24UNF	32.4	51	60.5
436-7522	1.0-10	1/32-3/8	1/2-20UNF	32.4	51	60.5
436-7523	1.0-13	1/32-1/2	3/8-24UNF	45	62	76
436-7524	1.0-13	1/32-1/2	1/2-20UNF	45	62	76
436-7525	1.0-16	1/32-5/8	5/8-16UNF	57	74	93
436-7526	0.6-6	1/64-1/4	B10	30.3	40	49
436-7527	1.0-10	1/32-3/8	B12	34	49	58.5
436-7528	1.0-13	1/32-1/2	B16	45	62	76
436-7529	1.0-16	1/32-5/8	B18	57	74	93
436-7530	0.6-6	1/64-1/4	JT1	30.3	40	49
436-7531	1.0-10	1/32-3/8	JT2	34	49	58.5
436-7532	1.0-13	1/32-1/2	JT33	45	62	76
436-7533	1.0-16	1/32-5/8	JT3	57	74	93

# DRILL CHUCKS

## Industrial keyed chuck

### Application

Recommended for Light , Medium and Heavy-Duty portable bench or floor mounted power tools.

### Features

- \* High precision threaded and tapered tightly mounts on the tools.
- \* Sleeve ,key hole and key are shaped by quenching.
- \* Jaws are specifically engineered for tight tolerance production drilling.
- \* Sleeve teeth and keyholes are shaped by cold pressing.
- \* Super precision and durable.

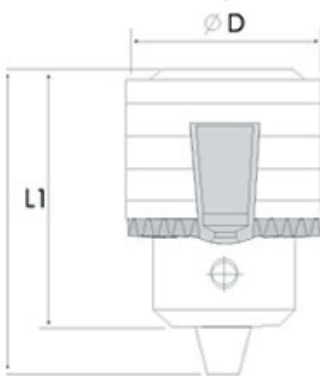

Order No.	Capacity		Mount	D	L1	L
	mm	Inch		mm	mm	mm
436-7300	1.0-10	1/32-3/8	3/8-24UNF	43.4	54	69.7
436-7301	1.0-10	1/32-3/8	1/2-20UNF	43.4	54	69.7
436-7302	1.0-13	1/32-1/2	1/2-20UNF	53.2	67	86
436-7303	1.0-10	1/32-3/8	B12	43.4	54	69.7
436-7304	1.0-13	1/32-1/2	B16	53.2	67	86
436-7305	3.0-16	1/8-5/8	B16	53.2	67	86
436-7306	3.0-16	1/8-5/8	B18	53.2	67	86
436-7307	1.0-16	1/32-5/8	B16	57	75	93
436-7308	1.0-16	1/32-5/8	B18	57	75	93
436-7309	5.0-20	3/16-3/4	B22	65.3	82	110
436-7310	1.0-10	1/32-3/8	JT2	43.4	54	69.7
436-7311	1.0-13	1/32-1/2	JT33	53.2	67	86
436-7312	1.0-13	1/32-1/2	JT6	53.2	67	86
436-7313	3.0-16	1/8-5/8	JT3	53.2	67	86
436-7314	3.0-16	1/8-5/8	JT33	53.2	67	86
436-7315	3.0-16	1/8-5/8	JT6	53.2	67	86
436-7316	1.0-16	1/32-5/8	JT3	57	75	93
436-7317	5.0-20	3/16-3/4	JT3	65.3	82	110

## Industrial keyed chuck

### Application

Recommended for Light , Medium and Heavy-Duty portable bench or floor mounted power tools.

### Features

- \* High precision threaded and tapered tightly mounts on the tools.
- \* Sleeve ,key hole and key are shaped by quenching.
- \* Jaws are specifically engineered for tight tolerance production drilling.
- \* Sleeve teeth and keyholes are shaped by cold pressing.
- \* Super precision and durable.

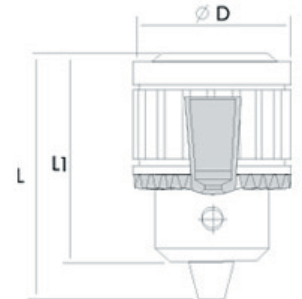

Order No.	Capacity		Mount	D	L1	L
	mm	Inch		mm	mm	mm
436-7318	0.6-6.5	1/64-1/4	B10	32	39.5	50
436-7319	0.5-10	1/64-3/8	B12	41.5	51	64
436-7320	0.5-13	1/64-1/2	B16	55.5	69	88.5
436-7321	1.0-16	1/32-5/8	B18	59	75.5	94.3
436-7322	5.0-20	3/16-3/4	B22	74	92	126
436-7323	5.0-25	3/16-1	B24	93.3	112	146
436-7324	0.6-6	1/64-1/4	JT1	32	50	39.5
436-7325	0.5-10	1/64-3/8	JT2	41.5	64	51
436-7326	0.5-13	1/64-1/2	JT33	55.5	88.5	69
436-7327	0.5-13	1/64-1/2	JT6	55.5	88.5	69
436-7328	1.0-16	1/32-5/8	JT3	59	94.3	75.5
436-7329	5.0-20	3/16-3/4	JT4	74	126	92
436-7330	5.0-25	3/16-1	JT5	93.3	146	112

## Industrial keyed chuck

Application

Recommended for Light , Medium and Heavy-Duty portable bench or floor mounted power tools.

Features

1. High precision threaded and tapered tightly mounts on the tools.
2. Sleeve ,key hole and key are shaped by quenching.
3. Jaws are specifically engineered for tight tolerance production drilling.
4. Sleeve teeth and keyholesare are shaped by cold pressing.
5. Super precision and durable.

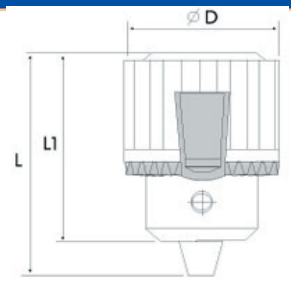

STYLE A



STYLE B

Order No.	Capacity		Mount	D	L1	L
	mm	Inch		mm	mm	mm
436-7331	0.6-6	1/64-1/4	3/8-24UNF	30.3	40	49
436-7332	1.0-10	1/32-3/8	3/8-24UNF	32.4	51	60.5
436-7333	1.0-10	1/32-3/8	1/2-20UNF	32.4	51	60.5
436-7334	1.0-13	1/32-1/2	3/8-24UNF	45	62	79
436-7335	1.0-16	1/32-5/8	5/8-16UNF	53	74	93
436-7336	0.6-6	1/64-1/4	B10	30.3	40	49
436-7337	1.0-10	1/32-3/8	B12	32.4	51	60.5
436-7338	1.0-13	1/32-1/2	B16	45	64	79
436-7339	1.0-16	1/32-5/8	B18	53	74	93
436-7340	0.6-6	1/64-1/4	JT1	30.3	40	49
436-7341	1.0-13	1/32-3/8	JT33	34	49	58.5
436-7342	1.0-13	1/32-1/2	JT6	42	59	71.5
436-7343	1.0-16	1/32-5/8	JT33	53	74	93
436-7344	1.0-19	1/32-3/4	JT4	67	97	120.5

## Industrial keyed chuck

Application: Recommended for Light, Medium and Heavy-Duty portable bench or floor mounted power tools.

Features:

- \* High precision threaded and tapered tightly mounts on the tools.
- \* Sleeve, key hole and key are shaped by quenching.
- \* Jaws are specifically engineered for tight tolerance production drilling.
- \* Sleeve teeth and keyholes are shaped by cold pressing.
- \* Super precision and durable.

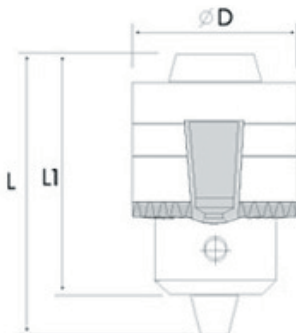

Order No.	Capacity		Mount	D	L1	L
	mm	Inch		mm	mm	mm
436-7345	1.0-10	1/16-3/8	3/8-24UNF	31	46	55.5
436-7346	1.0-10	1/16-3/8	1/2-20UNF	31	46	55.5
436-7347	1.5-13	1/16-1/2	3/8-24UNF	42	58.5	73
436-7348	1.5-13	1/16-1/2	1/2-20UNF	42	58.5	73
436-7349	1.0-13	1/32-1/2	B16	52	69	86
436-7350	3.0-16	1/8-5/8	B16	49.5	75	94
436-7351	3.0-16	1/8-5/8	B18	49.5	75	94
436-7352	1.0-16	1/32-5/8	B16	52	69	86
436-7353	1.0-16	1/32-5/8	B18	56	80	101
436-7354	5.0-20	3/16-3/4	B22	65	92	114
436-7355	5.0-25	3/16-1	B24	80	119	147
436-7356	1.0-13	1/32-1/2	JT33	52	69	86
436-7357	1.0-13	1/32-1/2	JT6	52	69	86
436-7358	1.0-16	1/32-5/8	JT3	52	69	86
436-7359	1.0-16	1/32-5/8	JT33	56	80	101
436-7360	5.0-20	3/16-3/4	JT3	65	92	114
436-7361	5.0-25	3/16-1	JT4	80	119	147

## Industrial keyed chuck

### Application

Recommended for Light , Medium and Heavy-Duty portable bench or floor mounted power tools.

### Features

- \* High precision threaded and tapered tightly mounts on the tools.
- \* Sleeve ,key hole and key are shaped by quenching.
- \* Jaws are specifically engineered for tight tolerance production drilling.
- \* Sleeve teeth and keyholes are shaped by cold pressing.
- \* Super precision and durable.

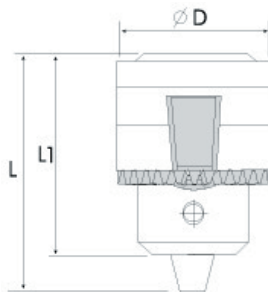

Order No.	Capacity		Mount	D	L1	L
	mm	Inch		mm	mm	mm
436-7362	0.6-6	1/64-1/4	3/8-24UNF	30.3	40	49
436-7363	1.0-10	1/32-3/8	3/8-24UNF	32.4	51	60.5
436-7364	1.0-10	1/32-3/8	1/2-20UNF	32.4	51	60.5
436-7365	1.0-13	1/32-1/2	3/8-24UNF	45	62	76
436-7366	1.0-13	1/32-1/2	1/2-20UNF	45	62	76
436-7367	1.0-13	1/32-1/2	5/8-16UNF	45	62	76
436-7368	1.0-16	1/32-5/8	5/8-16UNF	57	74	93
436-7369	0.6-6	1/64-1/4	B10	30.3	40	49
436-7370	1.0-10	1/32-3/8	B12	34	49	58.5
436-7371	1.0-13	1/32-1/2	B16	45	62	76
436-7372	1.0-16	1/32-5/8	B18	57	74	93
436-7373	0.6-6	1/64-1/4	JT10	30.3	40	49
436-7374	1.0-10	1/32-3/8	JT33	34	49	58.5
436-7375	1.0-13	1/32-1/2	JT6	45	62	76
436-7376	1.0-16	1/32-5/8	JT33	57	74	93
436-7377	1.0-19	1/32-3/4	JT4	67	97	120.5

## Industrial keyed chuck

### Features

- \* High precision threaded and tapered tightly mounts on the tools.
- \* Sleeve ,key hole and key are shaped by quenching.
- \* Jaws are specifically engineered for tight tolerance production drilling.
- \* Sleeve teeth and keyholes are shaped by cold pressing.
- \* Super precision and durable.

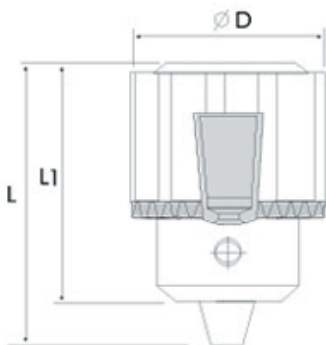

Order No.	Capacity		Mount	D	L1	L
	mm	Inch		mm	mm	mm
436-7378	0.6-6	1/64-1/4	B10	30.3	39.5	50
436-7379	1.0-10	1/32-3/8	B12	43.4	54	69.7
436-7380	1.0-13	1/32-1/2	B16	53.2	67	86
436-7381	3.0-16	1/8-5/8	B16	53.2	67	86
436-7382	3.0-16	1/8-5/8	B18	53.2	67	86
436-7383	1.0-16	1/32-5/8	B16	57	75	93
436-7384	1.0-16	1/32-5/8	B18	57	75	93
436-7385	5.0-20	3/16-3/4	B22	65.3	82	110
436-7386	0.6-6	1/64-1/4	JT1	30.3	39.5	50
436-7387	1.0-10	1/32-3/8	JT2	43.4	54	69.7
436-7388	1.0-13	1/32-1/2	JT33	53.2	67	86
436-7389	1.0-13	1/32-1/2	JT6	53.2	67	86
436-7390	3.0-16	1/8-5/8	JT3	53.2	67	86
436-7391	3.0-16	1/8-5/8	JT33	53.2	67	86
436-7392	3.0-16	1/8-5/8	JT6	53.2	67	86
436-7393	1.0-16	1/32-5/8	JT3	57	75	93
436-7394	1.0-19	1/32-3/4	JT4	65.3	82	110
436-7395	5.0-20	3/16-3/4	JT3	68	92	120